

CONDITIONAL WATER LICENCE

The owner of the land to which this licence is appurtenant is hereby authorized to divert and use water as follows:

- (a) The stream on which the rights are granted is Powerhouse Creek.
- (b) The point of diversion is located as shown on the attached plan.
- (c) The date from which this licence shall have precedence is 1st December, 1995.
- (d) The purpose for which this licence is issued is Industrial (bottling of water).
- (e) The maximum quantity of water which may be diverted is 227.3 cubic metre (50,000 gallons) a day.
- (f) Water may be used throughout the whole year.
- (g) The land upon which the water is to be used and to which this licence is appurtenant is Statutory Right of Way over unsurveyed Crown Land, Group 1, New Westminster District, shown outlined on Plan LMP53420, held under Lands File 2407414.
- (h) The authorized works constructed are diversion structure, pipe, loading valve and valve house, which shall be located approximately as shown on the attached plan. Any works necessary to permit trucking, off-loading and bottling of water are also authorized, within the Province of BC.
- (i) The construction of the said works has been completed and the water is being beneficially used. The licensee shall continue to make regular beneficial use of the water in the manner authorized herein.
- (j) The diversion of water authorized under this licence may be regulated at any time by an order of an Engineer under the *Water Act*, in order to maintain flow in the stream for the preservation of aquatic life. Regulation includes allowing, commencing, stopping, limiting, opening, shutting and prohibiting the diversion of water.
- (k) This licence is issued in substitution of Conditional Water Licence 115375.



Tim Bennett, P.Eng.
Assistant Regional Water Manager

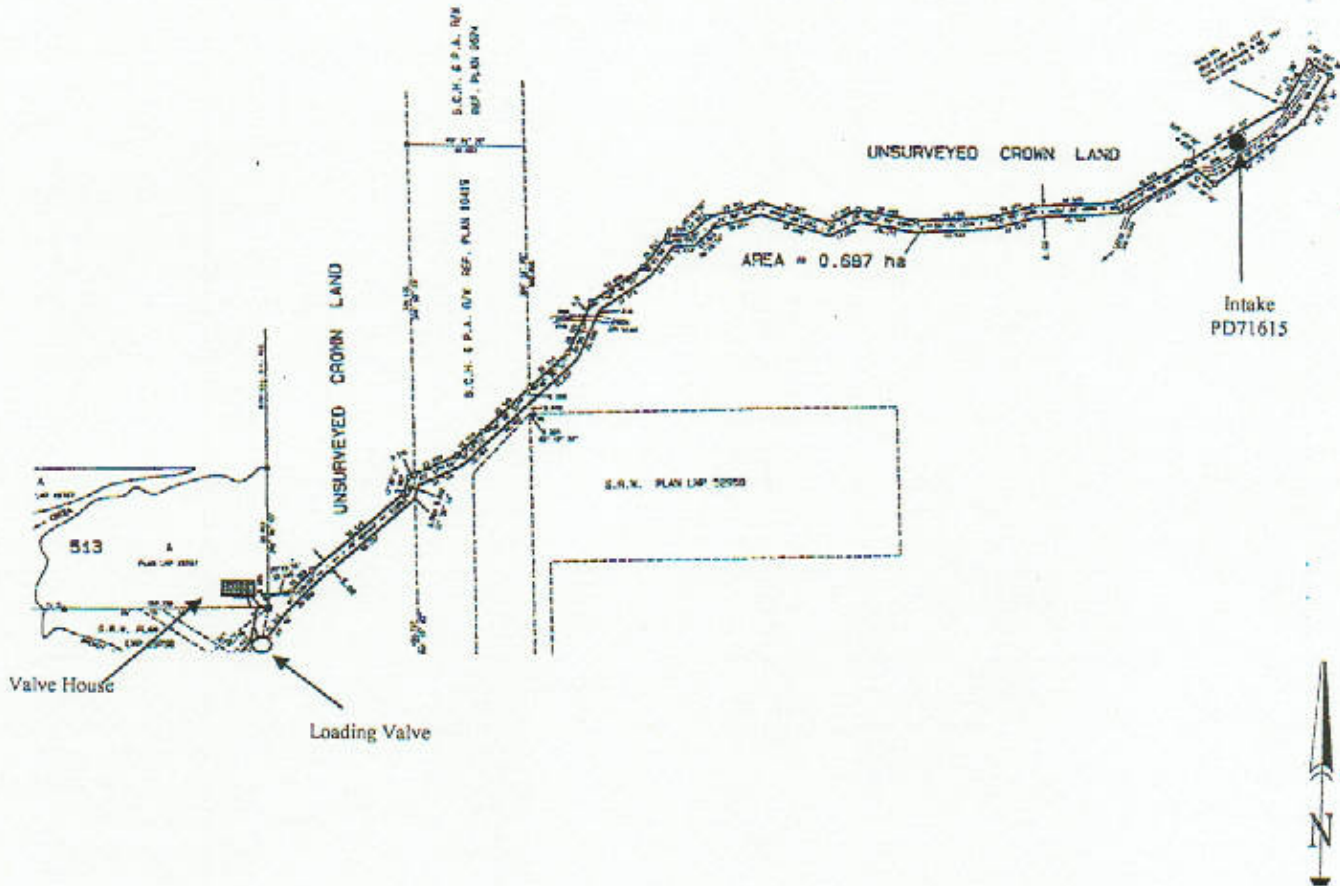

WATER DISTRICT: New Westminister
PRECINCT: 29C-Howe Sound
LAND DISTRICT: Group 1, New Westminister
MAP NUMBER: 92G/11h
PD NUMBER: 71615

Signature: TP
Date: Dec. 10, 2009

LEGEND

- Point of Diversion: ●
- Pipe: — — — — —
- Dwelling: ■
- Source: ~ ~ ~ ~ ~
- PCL: = = = = =

C.L.: 125046 for 115375
 File: 2002147

The boundaries of the land to which this license is appurtenant are shown thus: = = = = =

CONDITIONAL WATER LICENCE

The owner of the land to which this licence is appurtenant is hereby authorized to divert and use water as follows:

- (a) The stream on which the rights are granted is Powerhouse Creek.
- (b) The point of diversion is located as shown on the attached plan.
- (c) The date from which this licence shall have precedence is June 15, 2000.
- (d) The purpose for which this licence is issued is Industrial (bottling of water).
- (e) The maximum quantity of water which may be diverted is 454.6 cubic metre (100,000 gallons) a day.
- (f) Water may be used throughout the whole year.
- (g) The land upon which the water is to be used and to which this licence is appurtenant is Statutory Right of Way over Unsurveyed Crown Land, Group 1, New Westminster District, shown outlined on Plan LMP53420, held under Lands File 2407414.
- (h) The authorized works constructed are diversion structure, pipe, loading valve and valve house, which shall be located approximately as shown on the attached plan. Any works necessary to permit trucking, off-loading and bottling of water are also authorized, within the Province of BC.
- (i) The construction of the said works has been completed and the water is being beneficially used. The licensee shall continue to make regular beneficial use of the water in the manner authorized herein.
- (j) The diversion of water authorized under this licence may be regulated at any time by an order of an Engineer under the *Water Act*, in order to maintain flow in the stream for the preservation of aquatic life. Regulation includes allowing, commencing, stopping, limiting, opening, shutting and prohibiting the diversion of water.
- (k) This licence is issued in substitution of Conditional Water Licence 117101.



Tim Bennett, P.Eng.
Assistant Regional Water Manager

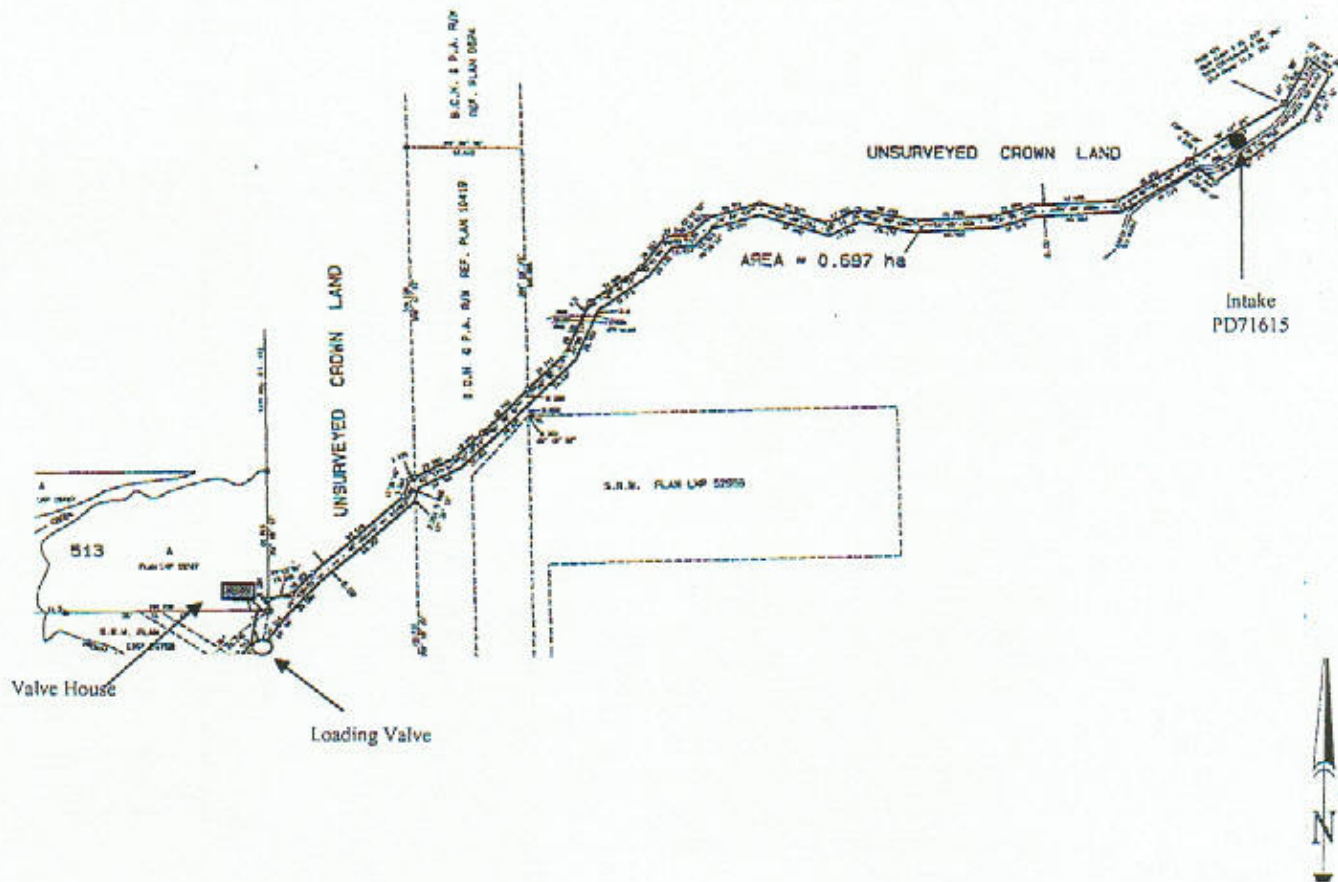

WATER DISTRICT: New Westminister
PRECINCT: 29C-Howe Sound
LAND DISTRICT: Group 1, New Westminister
MAP NUMBER: 92G/11h
PD NUMBER: 71615

Signature: T. B...
Date: 12-10-2009

LEGEND

- Point of Diversion: ●
- Pipe: - · - · - ·
- Dwelling: [shaded rectangle]
- Source: ~~~~~
- PCL: = = = = =

C.L.: 125055 for 117101
File: 2002577

The boundaries of the land to which this license is appurtenant are shown thus: _____

CONDITIONAL WATER LICENCE

The owner of the land to which this licence is appurtenant is hereby authorized to divert and use water as follows:

- (a) The stream on which the rights are granted is Powerhouse Creek.
- (b) The point of diversion is located as shown on the attached plan.
- (c) The date from which this licence shall have precedence is March 18, 2002.
- (d) The purpose for which this licence is issued is Industrial (bottling of water).
- (e) The maximum quantity of water which may be diverted is 3,864 cubic metre (850,000 gallons) a day.
- (f) Water may be used throughout the whole year.
- (g) The land upon which the water is to be used and to which this licence is appurtenant is Statutory Right of Way over Unsurveyed Crown Land, Group 1, New Westminster District, shown outlined on Plan LMP53420, held under Lands File 2407414.
- (h) The authorized works constructed are diversion structure, pipe, loading valve and valve house, which shall be located approximately as shown on the attached plan. Any works necessary to permit trucking, off-loading and bottling of water are also authorized, within the Province of BC.
- (i) The construction of the said works has been completed and the water is being beneficially used. The licensee shall continue to make regular beneficial use of the water in the manner authorized herein.
- (j) The diversion of water authorized under this licence may be regulated at any time by an order of an Engineer under the *Water Act*, in order to maintain flow in the stream for the preservation of aquatic life. Regulation includes allowing, commencing, stopping, limiting, opening, shutting and prohibiting the diversion of water.
- (k) This licence is issued in substitution of Conditional Water Licence 117244.



Tim Bennett, P.Eng.
Assistant Regional Water Manager

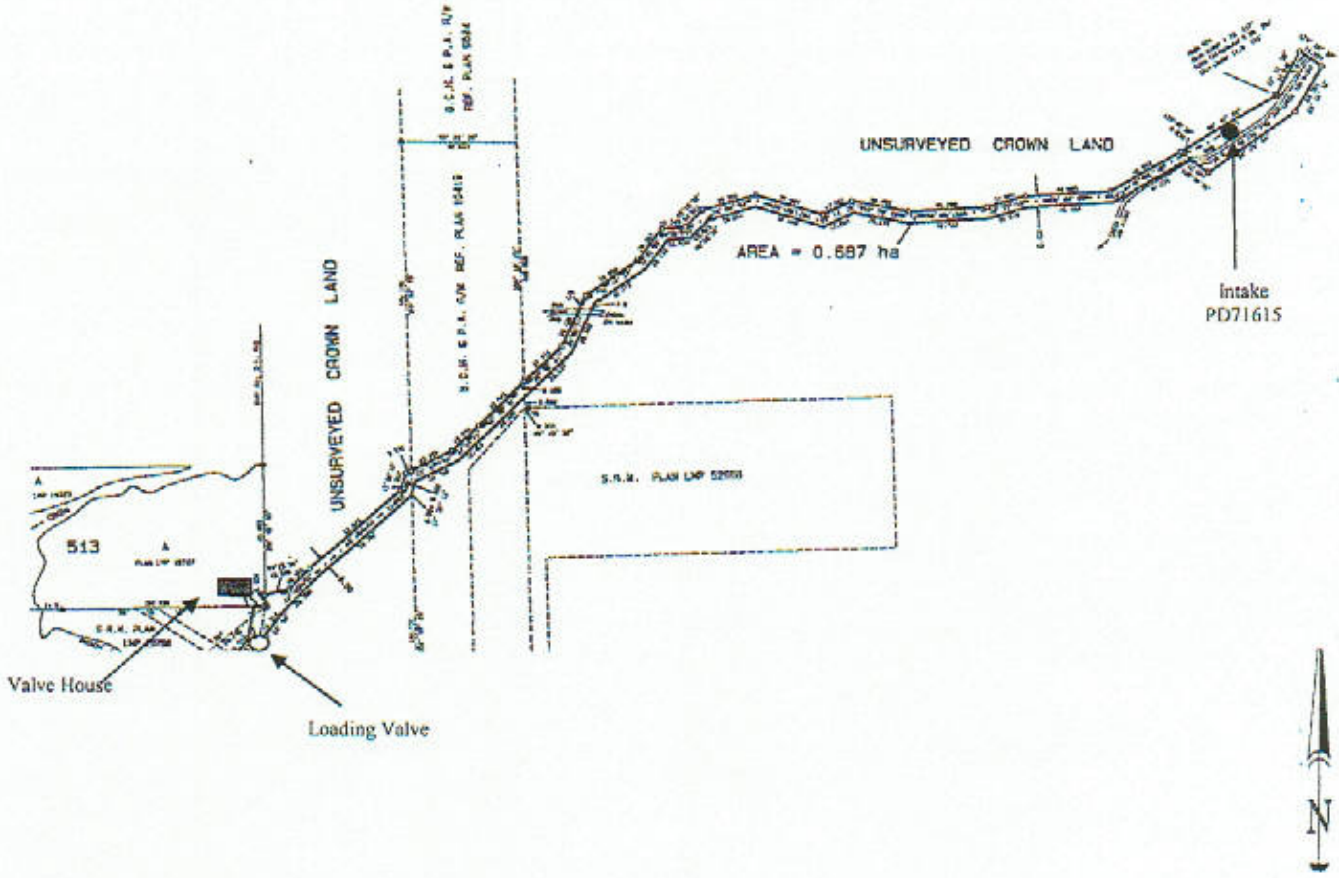

WATER DISTRICT: New Westminster
PRECINCT: 29C-Howe Sound
LAND DISTRICT: Group 1, New Westminster
MAP NUMBER: 92G/11h
PD NUMBER: 71615

Signature: *T.B.*

Date: Dec 10, 2007

LEGEND

- Point of Diversion: ●
- Pipe: — · — · — ·
- Dwelling: ■
- Source: ~~~~~
- PCL: ————

C.L.: 125056 for 117244

File: 2002593

The boundaries of the land to which this license is appurtenant are shown thus: ————